



UNIVERSITY OF MARYLAND
BALTIMORE
ADMINISTRATION & FINANCE

FACILITIES MANAGEMENT
ARCHITECTURE, ENGINEERING &
CONSTRUCTION DIVISION
229 ARCH STREET, OFFICE LEVEL 3
BALTIMORE, MARYLAND 21201
PHONE NO. (410) 706-7740
FAX NO. (410) 706-8547

NIH 100%
CONSTRUCTION
DOCUMENTS
SUBMISSION

A/E CONSULTANTS

ARCHITECT
Ayers/Saint/Gross
1040 Hull Street
Suite 100
Baltimore, MD 21203
Phone No. (410) 347-8500

M/E/P CONSULTANTS
Burdette, Koehler, Murphy, &
Associates
1423 Clarkview Road
Suite 500
Baltimore, MD 21209
Phone No. (410) 323-0600

PROFESSIONAL CERTIFICATION: I HEREBY CERTIFY THAT THESE DOCUMENTS WERE PREPARED OR APPROVED BY ME, AND THAT I AM A DULY LICENSED PROFESSIONAL ENGINEER UNDER THE LAWS OF THE STATE OF MARYLAND.
LICENSE NO. _____
EXPIRATION DATE: _____

REGISTRATION / STAMP

PROJECT TITLE :
BRESSLER RESEARCH BUILDING
SEVENTH FLOOR RENOVATION
NIH/NCR GRANT #:
1G20RR30969-01

UMB BUILDING NO. : 8050
UMB PROJECT NO. : 10 - 357
A/E PROJECT NO. : 21015.00
CAD FILE NO. :
DATE : MAY 19, 2011

DRAWING TITLE :
Seventh Floor
Plan

REVISIONS		
NO	DATE	ITEM
1	7/29/11	NIH REVIEW REVISIONS

DWG. NO.

A101A

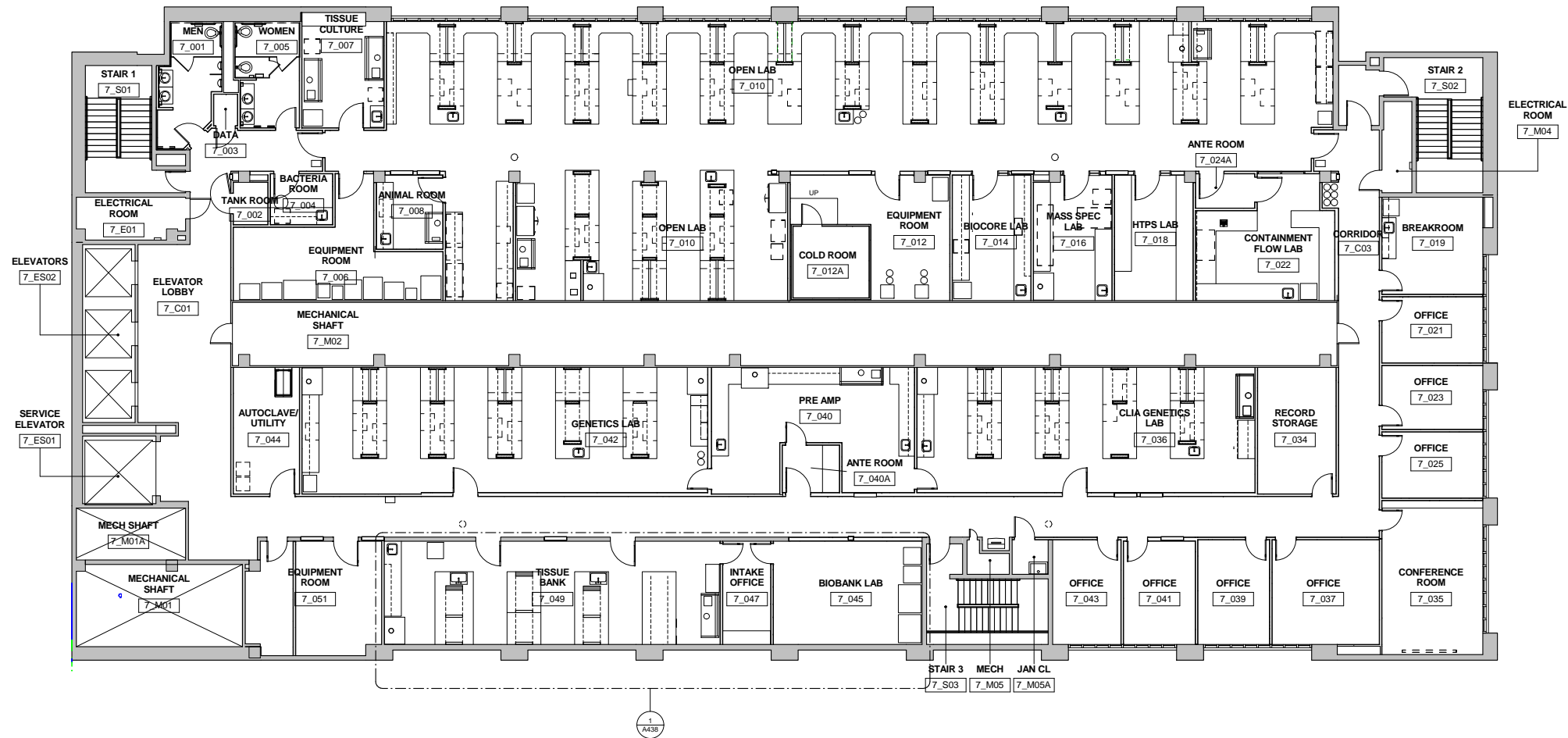

1 Seventh Floor Plan
A101A 1/8" = 1'-0"